

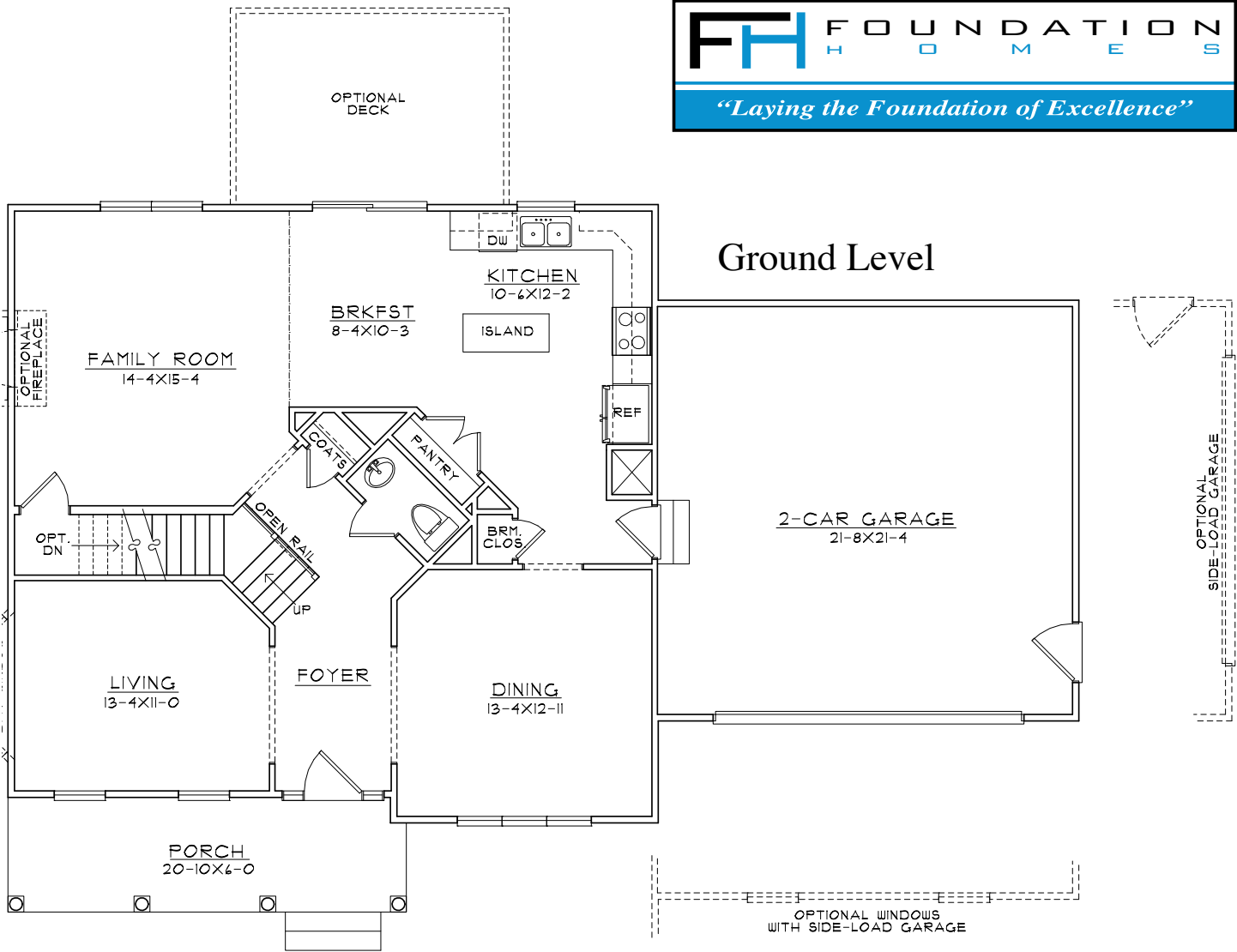

- ❖ Choice of Charming Exteriors
- ❖ Offering up to 3200 square feet of Living Space
- ❖ Presenting choices of with/without Garage & Basement to Accommodate Price-Point and Need
- ❖ Up-to 5 Bedrooms, 3.5 Baths
- ❖ Kitchen w/ Generous Cabinet Space Opens to Airy Breakfast Nook and Adjacent Family Room
- ❖ Spacious Owner's Suite Offering Dual Walk-In Closets & Luxury Master Bath w/ Double Vanity & Large Soaking Tub
- ❖ Upper Level Laundry Provides Convenience

# Haven



Elevations and floor plans are artist's renderings and accuracy cannot be guaranteed. All room dimensions are approximations only. Plan dimensions and features are subject to change without notice or obligation as a result of actual site conditions, which may dictate variations in style of windows, doors, number of steps and ceilings. Windows, doors and ceilings may vary depending on the options and elevations selected. Floor plans and elevations may also be altered to keep pace with Foundation Homes, Inc. ongoing design improvement program. Some features shown are options available at an additional cost and may not be available in all locations. This brochure is for illustrative purposes only and is not part of a legal contract. Please see Builder Representative for specific details.

